

ME by Starck One Piece Toilet # 217301..01 / 217301..85 / 217301..01 / 217301..85

| < 15 3/8 " > |

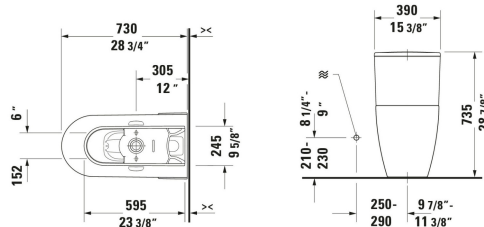

One Piece Toilet	Dimension	Weight	Order number
28 3/4 ", elongated, Siphonic, Flushing rim: Rimless, Outlet: vertical, Rough-in: 12 ", cUPC listed: Yes, cUPC listed: Yes, cUPC listed: Yes, cUPC listed: Yes			
Colors			
00 White 20 HygieneGlaze (an antibacterial ceramic glaze that provides almost indefinite effectiveness)			
Variant			
◆ White High Gloss, Dual Flush, Flush water quantity: 1.32/0.92 gal, Trip lever placement: Top, WaterSense: Yes	15 3/8 "x28 7/8 "	121.254 lb	217301..01
White High Gloss, Single Flush, Flush water quantity: 1.28 gal, Trip lever placement: Top, WaterSense: Yes, ADA: Yes	15 3/8 "x28 7/8 "	121.254 lb	217301..85
◆ White High Gloss, HygieneGlaze, Dual Flush, Flush water quantity: 1.32/0.92 gal, Trip lever placement: Top, WaterSense: Yes	15 3/8 "x28 7/8 "	121.254 lb	217301..01
White High Gloss, HygieneGlaze, Single Flush, Flush water quantity: 1.28 gal, Trip lever placement: Top, WaterSense: Yes, ADA: Yes	15 3/8 "x28 7/8 "	121.254 lb	217301..85
Spare parts			
Installation Set	2 3/8 x 5 1/8 "	1.874 lb	001417
Suitable products			
Toilet Seat Open front, elongated, 14 3/8 x 19 1/8 "	14 3/8 x 19 1/8 "		006431
Toilet Seat Slow close, Open front, elongated, 14 3/8 x 19 1/8 "	14 3/8 x 19 1/8 "		006439
Toilet Seat Slow close: No, Hinge material: Stainless Steel, elongated, 14 3/4 x 19 1/4 "	14 3/4 x 19 1/4 "		002021
Toilet Seat Slow close: Yes, Removable Seat, Hinge material: Stainless Steel, elongated, 14 3/4 x 19 1/4 "	14 3/4 x 19 1/4 "		002029
One Piece Toilet One Piece Toilet: 2173010001, elongated, Siphonic, Flushing rim: Rimless, Outlet vertical, Dual Flush, Trip lever placement: Top, Flush water quantity: 1.32 gal/0.92 gal, 15 3/8 x 28 3/4 "	15 3/8 x 28 3/4 "		D42018

**ME by Starck One Piece Toilet # 217301..01 / 217301..85 /
217301..01 / 217301..85**

|< 15 3/8 " >|

One Piece Toilet One Piece Toilet: 2173010085, elongated,
Siphonic, Flushing rim: Rimless, Outlet vertical, Single Flush,
Trip lever placement: Top, Flush water quantity: 1.28 gal, 15
3/8 x 28 3/4 "

15 3/8 x 28 3/4 "

D42019

All drawings contain the necessary measurements which are subject to standard tolerances. They are stated in inch & mm and are non-binding. Exact measurements, in particular for customized installation scenarios, can only be taken from the finished ceramic piece.