

ME by Starck One Piece Toilet # 217301..01 / 217301..85 / 217301..01 / 217301..85

|< 15 3/8 " >|

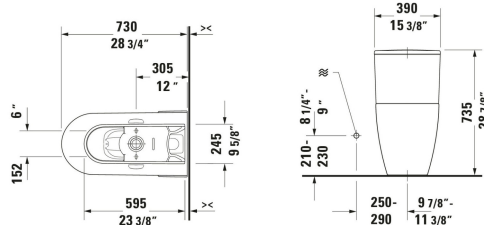

One Piece Toilet	Dimension	Weight	Order number
28 3/4 ", elongated, Siphonic, Flushing rim: Rimless, Outlet: vertical, Rough-in: 12 ", cUPC listed: Yes			
Colors			
00 White 20 HygieneGlaze (an antibacterial ceramic glaze that provides almost indefinite effectiveness)			
Variant			
White High Gloss, Dual Flush, Flush water quantity: 1.32/0.92 gal, Trip lever placement: Top, WaterSense: Yes	15 3/8 "x28 7/8 "	121.254 lb	217301..01
White High Gloss, Single Flush, Flush water quantity: 1.28 gal, Trip lever placement: Top, WaterSense: Yes, ADA: Yes	15 3/8 "x28 7/8 "	121.254 lb	217301..85
White High Gloss, HygieneGlaze, Dual Flush, Flush water quantity: 1.32/0.92 gal, Trip lever placement: Top, WaterSense: Yes	15 3/8 "x28 7/8 "	121.254 lb	217301..01
White High Gloss, HygieneGlaze, Single Flush, Flush water quantity: 1.28 gal, Trip lever placement: Top, WaterSense: Yes, ADA: Yes	15 3/8 "x28 7/8 "	121.254 lb	217301..85
Spare parts			
Installation Set	2 3/8 x 5 1/8 "	1.874 lb	001417
Suitable products			
Shower toilet seat Number of warm air dryer options: 4 Steps, Water position adjustment: 5 Steps, Number of spray intensity options: 3 Steps, Number of spray temperature options: 4 Steps, Water position adjustment: 5 Steps, Rearwash, Frontwash, Pulsing shower spray: Oscillating, Number of user profiles: 2, Self-cleaning function, Decalcification function, Night light, 14 5/8 x 20 1/4 "	14 5/8 x 20 1/4 "		610000
Toilet Seat Open front, elongated, 14 3/8 x 19 1/8 "	14 3/8 x 19 1/8 "		006431
Toilet Seat Slow close, Open front, elongated, 14 3/8 x 19 1/8 "	14 3/8 x 19 1/8 "		006439
Toilet Seat Slow close: No, Hinge material: Stainless Steel, elongated, 14 3/4 x 19 1/4 "	14 3/4 x 19 1/4 "		002021
Toilet Seat Slow close: Yes, Removable Seat, Hinge material: Stainless Steel, elongated, 14 3/4 x 19 1/4 "	14 3/4 x 19 1/4 "		002029

ME by Starck One Piece Toilet # 217301..01 / 217301..85 / 217301..01 / 217301..85

|< 15 3/8 " >|

One Piece Toilet One Piece Toilet: 2173010001, elongated, Siphonic, Flushing rim: Rimless, Outlet vertical, Dual Flush, Trip lever placement: Top, Flush water quantity: 1.32 gal/0.92 gal, 15 3/8 x 28 3/4 "	15 3/8 x 28 3/4 "	D42018
One Piece Toilet One Piece Toilet: 2173010085, elongated, Siphonic, Flushing rim: Rimless, Outlet vertical, Single Flush, Trip lever placement: Top, Flush water quantity: 1.28 gal, 15 3/8 x 28 3/4 "	15 3/8 x 28 3/4 "	D42019
One Piece Toilet One Piece Toilet: 2173010001, elongated, Siphonic, Flushing rim: Rimless, Outlet vertical, Dual Flush, Trip lever placement: Top, Flush water quantity: 1.32 gal/0.92 gal, 15 3/8 x 28 3/4 "	15 3/8 x 28 3/4 "	D42028
One Piece Toilet One Piece Toilet: 2173010085, elongated, Siphonic, Flushing rim: Rimless, Outlet vertical, Single Flush, Trip lever placement: Top, Flush water quantity: 1.28 gal, 15 3/8 x 28 3/4 "	15 3/8 x 28 3/4 "	D42029

All drawings contain the necessary measurements which are subject to standard tolerances. They are stated in inch & mm and are non-binding. Exact measurements, in particular for customized installation scenarios, can only be taken from the finished ceramic piece.